

产品特性/Product Features

- IP6K9K
- 30A 85°C
- 12-750VDC
- 1000MΩ (1000VDC) , IEC 60664-1

触点参数 / Contact parameters

		1a	
		≤5m (at 30A)	
		30A	
		2×10 ⁵	
		450V型	750V型
		1000VDC	1000VDC
		300A(320VDC)1	300A(320VDC)1
		13.5kW	22.5kW
1)		2×10 ⁴ 450VDC, 30A	1×10 ⁴ 750VDC, 30A
		7.5×10 ⁴ 450VDC, 30A	7.5×10 ⁴ 450VDC, 30A
2)	30A:		
	60A:60min		
	80A:20min		
	160A:30s		
	300A:0.6S		
1	23°C	0.6s	5.4s
2	85°C	10mm ²	-

性能参数 / Performance parameters

		1000MΩ(1000VDC)
		3000VAC 1min
		3000VAC 1min
()		≤30ms
()		≤10ms
		196m/s ²
		490m/s ²
		10Hz ~ 500Hz 49m/s ²
		5% ~ 85%RH
		-40°C ~ 85°C
		4M
		130g
		53.7mm×36.2mm×39.5mm

线圈参数 / Coil parameters

线圈匝数 Coil turns	线圈长度 Coil length	线圈直径 Coil diameter	线圈功率 Coil power
12	9	1.2	3.6W
24	18	2.4	3.8W

-40°C ~ 85°C)

外形图、安装孔尺寸 / Outline drawing, mounting hole size

/Unit mm



安装孔尺寸 / 接线图 Mounting hole size/Wiring diagram

Mounting hole size

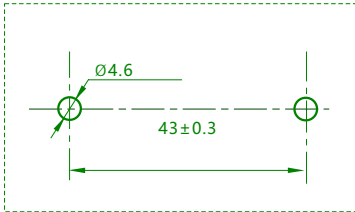

Wiring diagram

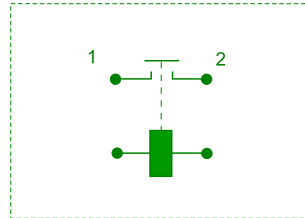

性能曲线图 Performance graph

Electrical life curve

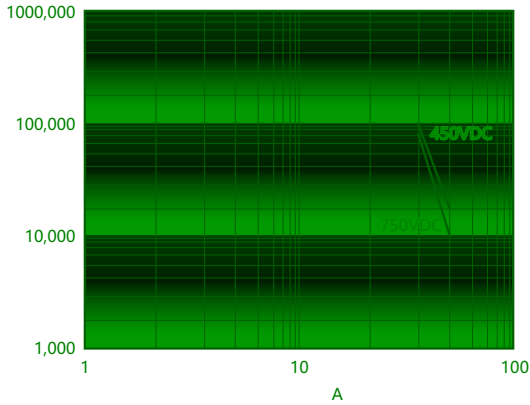

Tolerance curve

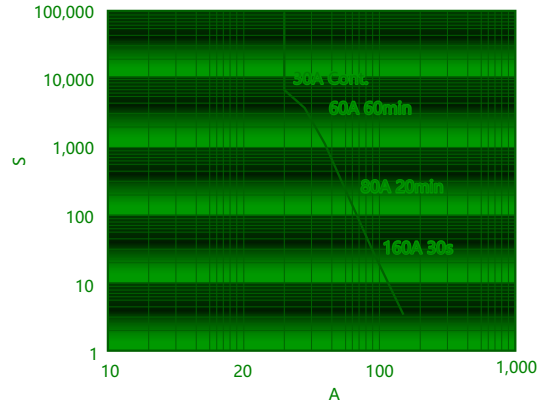

/ 0.6S 5.4S

85°C, 10mm²



使用注意事项 Precautions for use

1

M4	1.8N·m 2.7N·m	Ø4.0~Ø4.5mm	3mm	M4螺钉	1.8N·m~2.7N m
----	---------------	-------------	-----	------	---------------

2

10mm²

3

3mm



声明/Statement: