



### 产品特性/Product Features

- 额定电压: 12-750VDC
- 额定电流: 150A 85°C长时间载流能力
- 额定短路分断能力: 1500A(320VDC)1
- 额定短路分断能量: 67.5kW
- 额定峰值耐受电流: 1000A
- 额定峰值耐受能量: 9V0.1A
- 额定电寿命: 50000次
- 额定机械寿命: 100000次
- 防护等级: IP6K9K
- 符合标准: IEC 60664-1
- 支持PWM

### 主要性能指标/Main Performance Indicators

		1a	
		≤0.5m (at 150A)	
		150A	
		2×10 <sup>5</sup>	
		450V型	750V型
		750VDC	750VDC
		1500A(320VDC)1	1500A(320VDC)1
		67.5kW	112.5kW
1)		5×10 <sup>3</sup> 450VDC, 150A	1×10 <sup>3</sup> 750VDC, 150A
		500 450VDC, -150A	500 750VDC, -150A
		1 320VDC, 1000A	1 320VDC, 1000A
		150A:	
		200A:10min	
		300A:1min	
		1000A:1s	
辅助接点	Ue	1NO	
		30VDC/125VAC	
		2A DC /3A AC	
		9V0.1A	

1) 23°C, 0.6s:5.4s。

2) 85°C, 50 mm<sup>2</sup>, \* \* \*





Mounting hole size

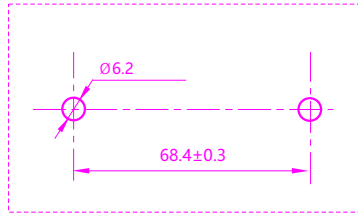

Wiring diagram

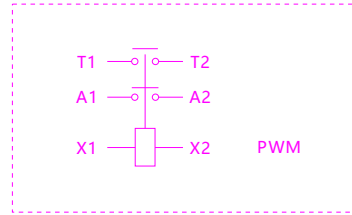

Electrical life curve

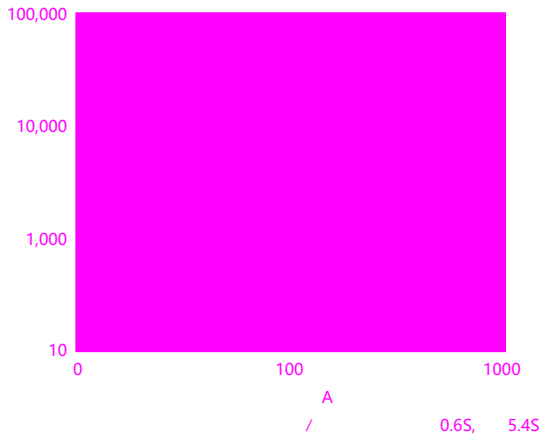

Tolerance curve

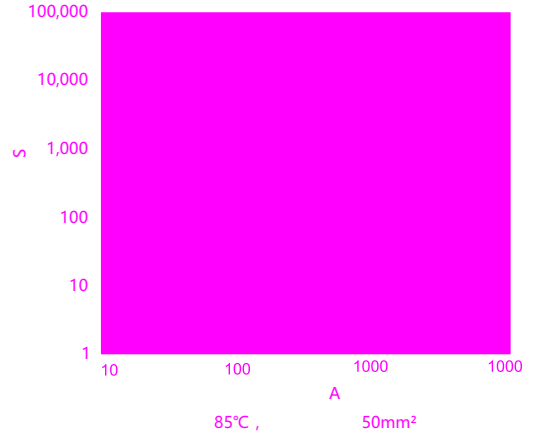

1

M5螺钉 内螺纹	3N-m 4N-m	Ø5.0-Ø5.5	3mm	M5螺钉	3N-m~4N-m
M8	10N-m~12N-m	Ø8.0-Ø8.5	3mm		

2 50m  
3 3mm

**声明/Statement:**

